



PRODUCT GUIDE

FLRSBA



DOCUMENT NUMBER

REVISION DATE
20190702

TERMS OF USE

Automotive Data Solutions Inc. ("ADS") products are strictly intended for installation by Certified Technicians who are employed by a registered business specialized in the installation of automotive aftermarket electronics products. Prior to beginning installation of an ADS product in a vehicle, it is the Certified Technician's responsibility to review the most current Product Guide, Install Guide and vehicle-specific notes available in Weblink®. ADS is not responsible for any damages whatsoever, including but not limited to any consequential damages, incidental damages, damages for loss of time, loss of earnings, loss of profit, commercial loss, loss of economic opportunity and the like that may or may not have resulted from the use, misuse, improper installation or operation of its products. ADS reserves itself the right to suspend any Weblink® account without notice and decline to offer technical support to non-Certified Technicians, non-compliant Certified Technicians or end users.

WELCOME

Congratulations on the purchase of your FLRSBA solution. You are now a few simple steps away from enjoying your new remote starter unit with enhanced features.

Before starting your installation, please ensure that your FLRSBA module is programmed with the correct firmware for your vehicle and that you carefully review the install guide.

TABLE OF CONTENTS

PRESTIGE

Box Contents	4
Compatible Accessories	5-6
Tach Programming Procedure	7
Remote Programming Procedure	8
Valet Mode Programming Procedure	9-13
Online Module Settings	14
Module Diagnostics	15
Remote Starter Error Codes	16
Module Reset Procedure	17

PURSUIT

Box Contents	18
Compatible Accessories	19-20
Tach Programming Procedure	21
Remote Programming Procedure	22
Valet Mode Programming Procedure	23-27
Online Module Settings	28
Module Diagnostics	29
Remote Starter Error Codes	30
Module Reset Procedure	31

TABLE OF CONTENTS

CODE ALARM

Box Contents	32
Compatible Accessories	33-34
Tach Programming Procedure	35
Remote Programming Procedure	36
Valet Mode Programming Procedure	37-38
Online Module Settings	39
Module Diagnostics	40
Remote Starter Error Codes	41
Module Reset Procedure	42

DIRECTED

Box Contents	43
Compatible Accessories	44-45
Tach Programming Procedure	46
Remote Programming Procedure	47
Valet Mode Programming Procedure	48
Online Module Settings	49
Module Diagnostics	50
Remote Starter Error Codes	51
Module Reset Procedure	52

NEED HELP?

 **1 800 225-6074**

 www.voxxelectronics.com/care/?p=contactus

 www.flashlogic.com/support
www.facebook.com/audiovox

BOX CONTENTS

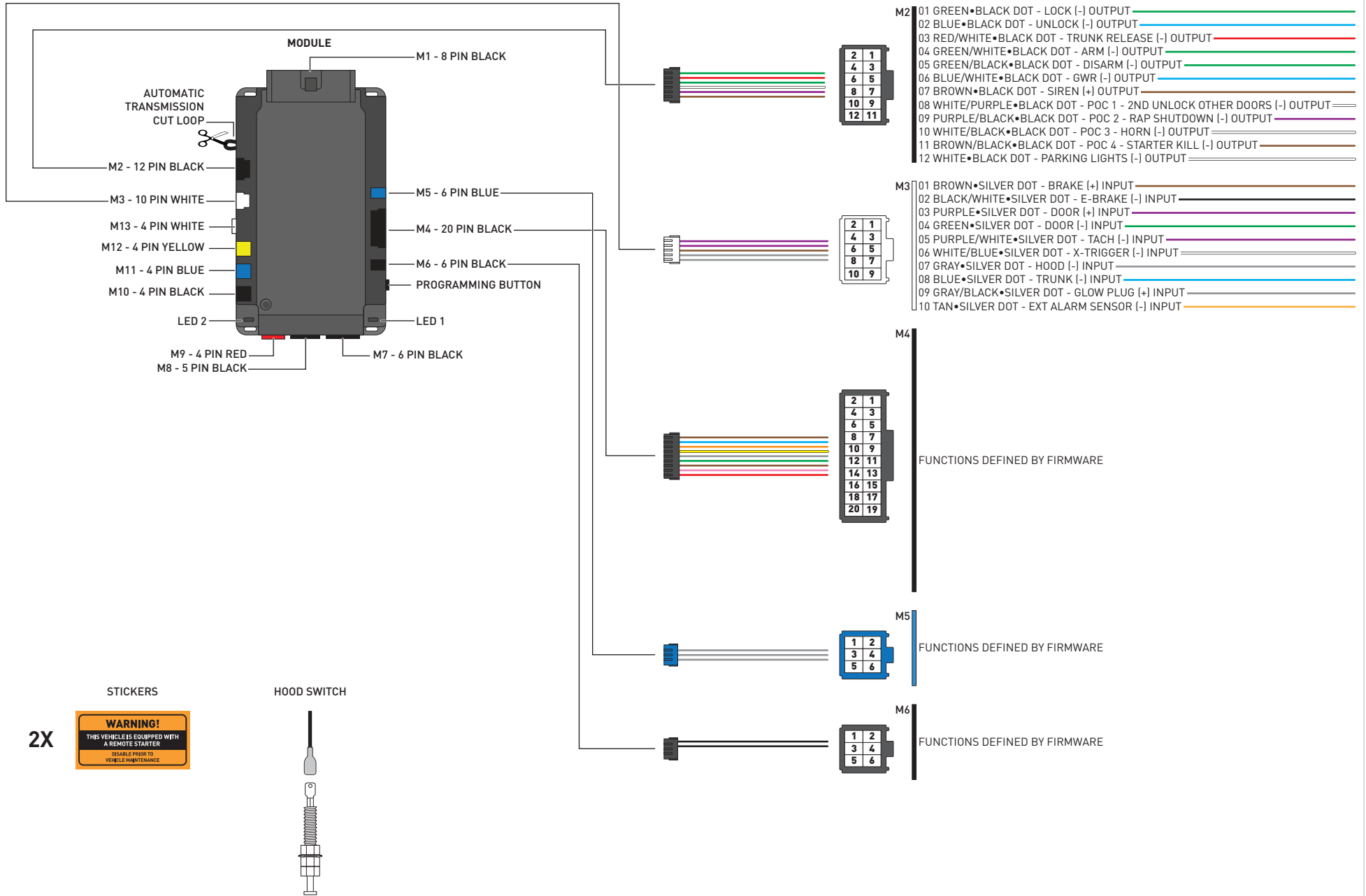

FLASHLOGIC: ADSAHRPWR **HIGH CURRENT HARNESS** **SOLD SEPARATELY**



FLASHLOGIC: FLPROG **WEBLINK CABLE** **SOLD SEPARATELY**



FLASHLOGIC: FLWLMAN1, FLWLMP1 **WEBLINK MOBILE** **SOLD SEPARATELY**

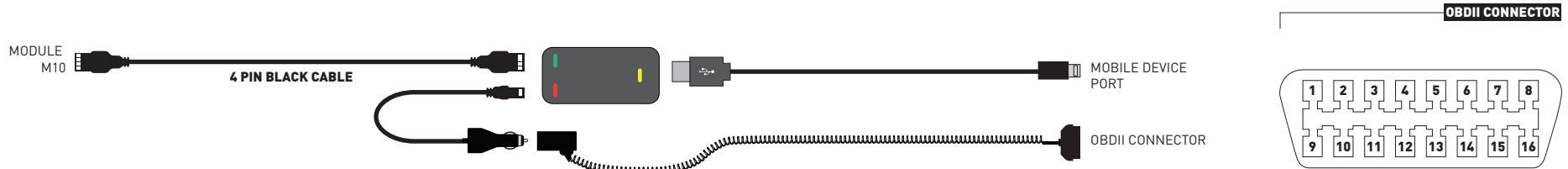

FLASHLOGIC: BASEC / VOXX: DUB1, CAGBS, MV3, AS9492A, AS94954P **SECURITY PACKAGE** **SOLD SEPARATELY**

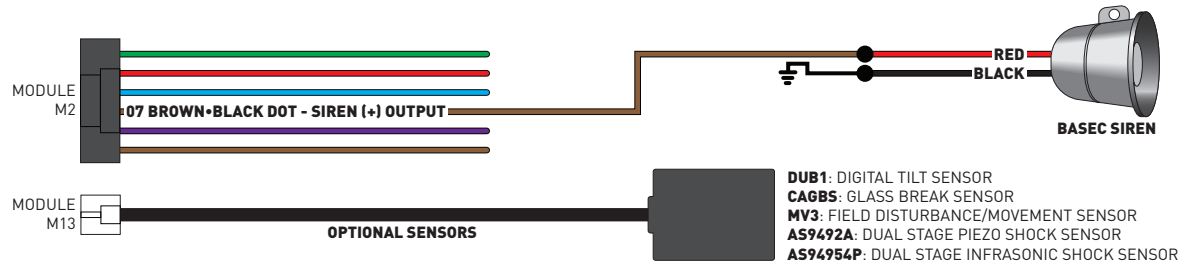

TO ACTIVATE THE BUILT-IN TILT & SHOCK SENSOR, THE SHOCK SENSOR PORT FOR COMPATIBLE ACCESSORIES AND THE SIREN OUTPUT:
 1-LOG INTO YOUR WEBLINK ACCOUNT.
 2-CONNECT YOUR CONTROL MODULE AND FOLLOW THE PROGRAMMING STEPS.
 3-SELECT BASEC AND ENTER THE 16 DIGIT ACTIVATION CODE.
 4-PROCEED WITH THE PROGRAMMING STEPS AND INSTALLATION.



PRESTIGE: PE1B, PE1BTW, PE2LED, PE2LCD, PE5B

RF KIT

SOLD SEPARATELY

MODULE
M7



ANTENNA

CARLINK: ASCL6, ASCLBTLR

TELEMATIC KIT

SOLD SEPARATELY

MODULE
M11



(NC)

01



START vehicle for 15 seconds.

02



Press and hold the brake pedal.

03



Press and release the module's programming button. (OR if the remotes are already programmed to the vehicle, press and hold the start button of the remote for 2.5 seconds.)

04



Wait, LED 2 will flash GREEN. (See the Module Diagnostics page)

05





Release the brake pedal.

06



Module Programming Procedure completed.

>>  The following procedure is valid for PRESTIGE and PURSUIT RF kits. It programs aftermarket remotes to the remote starter.

>>  WARNING: Program aftermarket remotes before usage. A maximum of four [4x] aftermarket remotes per system.

01 Set ignition to ON position.



02 Press and release the antenna button three times [3x].



03 The parking lights will flash once [1x], the horn will chirp once [1x].



04 The remote starter LED will turn RED and the antenna LED will flash.

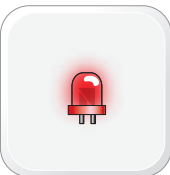

05 Press once [1x] on LOCK button of aftermarket remote.



06 The remote starter LED will flash GREEN once [1x] then will turn RED.



07 To program additional remotes: repeat steps 5 to 6 using each additional remote.



08 Set ignition to OFF position.



09 The remote starter LED will turn OFF and the antenna LED will turn OFF.



10 The parking lights will flash twice [2x], the horn will chirp twice [2x].



11 Remote Programming completed.

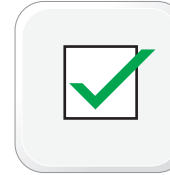

>>  TO DELETE ALL REMOTES: repeat steps 1 to 4 then press and hold the antenna button for 6 seconds. The parking lights will flash twice [2x], the horn will chirp twice [2x].

>>



The following procedure is valid for PRESTIGE and PURSUIT RF kits. It triggers the Valet Mode for remote start only.

01



NOTE: In Valet Mode, the Remote starter is not functional. Keyless entry, Lock and Unlock will remain functional.

02



Set ignition to OFF position.

03



Press and hold the antenna button.

04



Cycle ignition ON three times [3x ON/OFF] rapidly.

05



The parking lights will flash once [1x], the horn will chirp once [1x], the antenna LED will flash twice [2x] rapidly then once [1x].

06



Valet Mode completed.

07



To exit valet mode, repeat steps 2 to 4. The parking lights will flash twice [2x], the horn will chirp twice [2x], the antenna LED will turn OFF.

>>



The following procedure is valid for PRESTIGE and PURSUIT RF kits. It triggers the Valet Mode for alarm only.

01



NOTE: In Valet Mode, the alarm is disabled and the Remote starter is functional. Keyless entry, Lock and Unlock will remain functional.

02



Set ignition to ON position.

03



Press and hold the antenna button for 5 seconds.

04



The parking lights will flash once [1x], the horn will chirp once [1x], the antenna LED will turn ON.

05



Set ignition to OFF position.

06



Valet Mode completed.

07



To exit valet mode, repeat steps 2 to 3. The parking lights will flash twice [2x], the horn will chirp twice [2x], the antenna LED will turn OFF.

>>



The following procedure is valid for PRESTIGE and PURSUIT RF kits. It triggers the Valet Mode for remote start and alarm if the alarm override option is set to valet switch (Menu 3, Option 22).

01



NOTE: In Valet Mode, the Remote starter is not functional. Keyless entry, Lock and Unlock will remain functional.

02



Cycle ignition ON twice [2x OFF/ON] rapidly.

03



Press and release the BRAKE pedal three times [3x].

04



The parking lights will flash once [1x], the horn will chirp once [1x], the antenna LED will turn ON.

05



Set ignition to OFF position.

06



Valet Mode completed.

07



To exit valet mode, repeat steps 2 to 3. The parking lights will flash twice [2x], the horn will chirp twice [2x], the antenna LED will turn OFF.

>>



The following procedure is valid for PRESTIGE and PURSUIT RF kits. It triggers the Valet Mode with a custom code override. The default override code is 11.

01



NOTE: In Valet Mode, the Remote starter is not functional. Keyless entry, Lock and Unlock will remain functional.

02



Set ignition to ON position.

03



Press the antenna programming button once [1x].

04



Cycle ignition ON once [1x OFF/ON] rapidly.

05



Press the antenna programming button once [1x].

06



Cycle ignition ON once [1x ON/OFF] rapidly.

07



Set ignition to START position. (Engine running.)

08



Set ignition to OFF position.

09

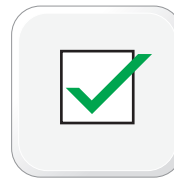

Valet Mode completed.

>>



The following procedure is valid for PRESTIGE and PURSUIT RF kits. It sets a new custom code override to trigger the Valet Mode.

01



Press once [1x] on the unlock button of the aftermarket remote.

02



Set ignition to ON position.

03



TIME RESTRICTION. Complete steps 4 to 9 within 45 seconds.

04



Press the antenna programming button three times [3x].

05



Cycle ignition ON three times [3x OFF/ON] rapidly.

06



Press the antenna programming button up to 9 times, to set the tenths digit from 1 to 9. Each button press increments the digit by one.

07



Cycle ignition ON once [1x OFF/ON] rapidly.

08



Press the antenna programming button up to 9 times, to set the tenths digit from 1 to 9. Each button press increments the digit by one.

09



Set ignition to OFF position.

10



LED will flash as many times as the tenths digit, then will flash as many times as the units digit.

11



Valet Mode completed.

WEB PROGRAMMABLE MENUS	DESCRIPTION
MENU 1 – Remote Starter	RS related configuration options
MENU 2 – Doorlock Options	Convenience feature configuration options
MENU 3 – Security Options	Alarm activation and settings
MENU 4 – AUX function assignments	Set transmitter AUX buttons controls
MENU 5 – Programmable outputs (POC)	Set actions for programmable outputs
MENU 6 – Pulse Timer Output Configuration (PTO)	Set duration for pulse timer outputs (if used)
MENU 7 – Input Configurations	Set inputs for Auto by firmware/Data/Analog
MENU 8 – Output Configurations	Set outputs for Auto by firmware/Data/Analog

Programming options are available through Weblink and Weblink Mobile only.

TEST MODULE		LED 1 STATUS	DIAGNOSTIC
I	DURING MODULE PROGRAMMING	Flashing RED	Missing/wrong information from firmware or vehicle.
		Solid RED	Module waiting for more vehicle information.
		Flashing GREEN	Additional steps required to complete module programming.
		Solid GREEN then OFF	Module correctly programmed.
		OFF	No activity or module already programmed.
II	DURING TACH PROGRAMMING	1 GREEN flash	Tach signal programmed in Analog
		2 GREEN flashes	Tach signal programmed in Data
		3 RED flashes	No tach signal detected
		4 RED flashes	System is in valet mode
		6 RED flashes	Tach set for 'assumed start'. No tach programming required
III	DURING REMOTE START	Flashing RED	Module incorrectly programmed.
		Solid RED	Module incorrectly programmed.
		Flashing GREEN	Module correctly programmed and operational.
		Solid GREEN then OFF	Reset in progress.
		OFF	Invalid ground when running status from remote starter.
IV	WITH IGNITION OFF	Flashing RED	Module incorrectly programmed or connected.
		Solid RED	Module not programmed. Waiting for more vehicle information.
		Flashing GREEN	False ground when running status from remote starter.
		Solid GREEN then OFF	Reset in progress.
		OFF	Module at rest and ready for a remote start sequence.

REMOTE STARTER ERROR CODES: NOTES	[X] NUMBER OF PARKING LIGHT FLASHES	DIAGNOSTIC
I WARNING: The following applies only when the parking lights are connected and supported by the system.	01	Engine running.
	02	Key in ignition at ON position.
II After a remote starter failure, the parking lights will flash three [3x] times, then will flash [X] number times to indicate an error code. See table.	03	Door is open.
	04	Trunk is open.
	05	Foot brake is ON.
	06	Hood is open.
	07	The reservation is OFF. (Manual transmission only)
	08	Tach failure.
	09	The vehicle is moving (VSS).
	10	System is in Valet Mode.
	11	CAN communication failure
	12	RS not synchronized. Start vehicle with OEM key for 15 sec before trying a new RS sequence.
	13	Bypass problem.

REMOTE STARTER SHUTDOWN ERROR CODES: NOTES	[Y] NUMBER OF PARKING LIGHT FLASHES	DIAGNOSTIC
I WARNING: The following applies only when the parking lights are connected and supported by the system.	01	Engine tach signal is lost.
	02	Emergency brake is lost.
II If the engine shuts down after a remote starter sequence: Press and hold the Trunk button and the Start button at the same time for 2.5 seconds when using a 1-WAY remote. OR Press once [1x] on button "4" when using a 2-WAY remote. The parking lights will flash four [4x] times, then will flash [Y] number times to indicate an error code. See table.	03	Foot brake is ON.
	04	Hood is open.
	05	Engine RPM limiter is ON.
	06	Glow plug timeout error.
	07	Vehicle is moving (VSS).
	08	N/A
	09	N/A
	10	Door is open.
	11	CAN communication failure during RS sequence.
	12	RS not synchronized. Start vehicle with OEM key for 15 sec before trying a new RS sequence.
	13	Takeover is not allowed.
	14	Shutdown error, board overheat protection.

>>



The following procedure resets the module programming to the vehicle. It does not reset any settings configured online.

01

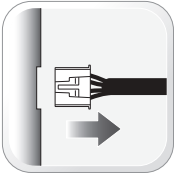

Disconnect all connectors from module except the M1 BLACK 8-pin connector and the M4 BLACK 20-pin connector.

02

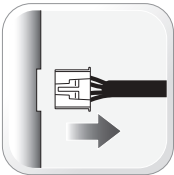

Disconnect the M1 BLACK 8-pin connector and the M4 BLACK 20-pin connector.

03



PRESS AND HOLD the module's programming button while connecting the M1 BLACK 8-pin connector and the M4 BLACK 20-pin connector.

04



Wait, LED 1 will flash RED. RELEASE programming button.

05

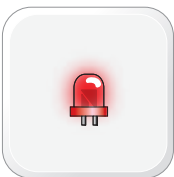

LED 1 will turn RED for 2 seconds.

06



Module RESET completed.

07

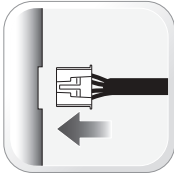

Reconnect all connectors.

08



Repeat programming procedure.

>>



Failure to follow procedure may result with a DTC or a CHECK ENGINE error message.

BOX CONTENTS

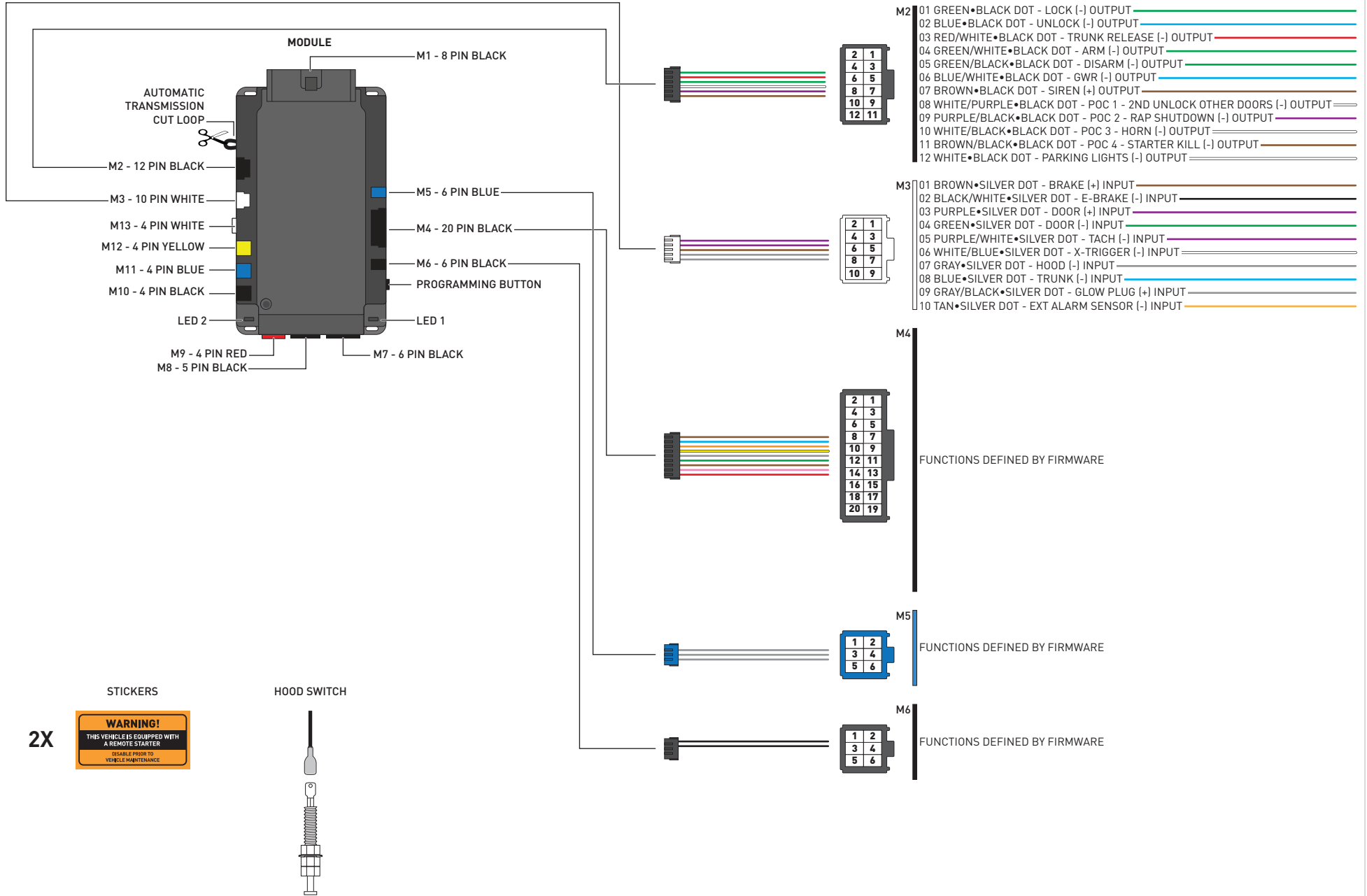

FLASHLOGIC: ADSAHRPWR **HIGH CURRENT HARNESS** **SOLD SEPARATELY**



FLASHLOGIC: FLPROG **WEBLINK CABLE** **SOLD SEPARATELY**



FLASHLOGIC: FLWLMAN1, FLWLMP1 **WEBLINK MOBILE** **SOLD SEPARATELY**

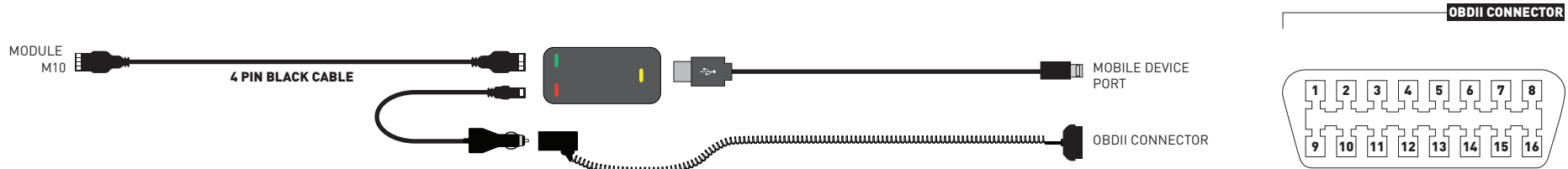

FLASHLOGIC: BASEC / VOXX: DUB1, CAGBS, MV3, AS9492A, AS94954P **SECURITY PACKAGE** **SOLD SEPARATELY**

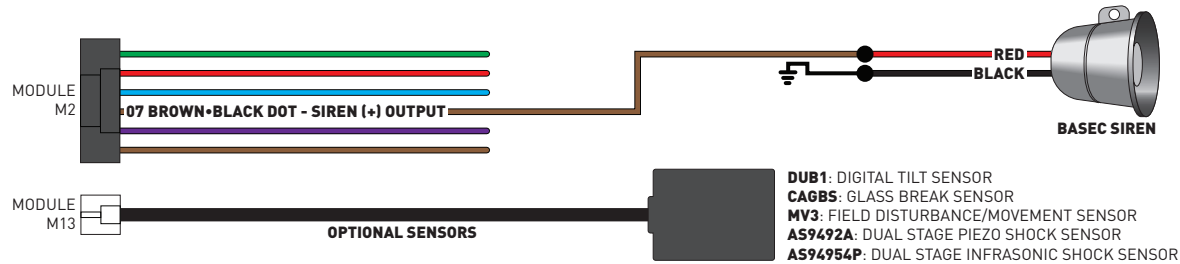

TO ACTIVATE THE BUILT-IN TILT & SHOCK SENSOR, THE SHOCK SENSOR PORT FOR COMPATIBLE ACCESSORIES AND THE SIREN OUTPUT:

- 1-LOG INTO YOUR WEBLINK ACCOUNT.
- 2-CONNECT YOUR CONTROL MODULE AND FOLLOW THE PROGRAMMING STEPS.
- 3-SELECT BASEC AND ENTER THE 16 DIGIT ACTIVATION CODE.
- 4-PROCEED WITH THE PROGRAMMING STEPS AND INSTALLATION.



PURSUIT: PRE1BTW

RF KIT

SOLD SEPARATELY

MODULE
M7



ANTENNA

CARLINK: ASCL6, ASCLBTLR

TELEMATIC KIT

SOLD SEPARATELY

MODULE
M11



(NC)

01



START vehicle for 15 seconds.

02



Press and hold the brake pedal.

03



Press and release the module's programming button. (OR if the remotes are already programmed to the vehicle, press and hold the start button of the remote for 2.5 seconds.)

04



Wait, LED 2 will flash GREEN. (See the Module Diagnostics page)

05





Release the brake pedal.

06



Module Programming Procedure completed.

>>  The following procedure is valid for PRESTIGE and PURSUIT RF kits. It programs aftermarket remotes to the remote starter.

>>  WARNING: Program aftermarket remotes before usage. A maximum of four [4x] aftermarket remotes per system.

01 Set ignition to ON position.



02 Press and release the antenna button three times [3x].



03 The parking lights will flash once [1x], the horn will chirp once [1x].



04 The remote starter LED will turn RED and the antenna LED will flash.

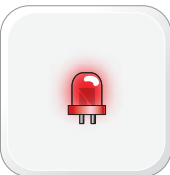

05 Press once [1x] on LOCK button of aftermarket remote.



06 The remote starter LED will flash GREEN once [1x] then will turn RED.



07 To program additional remotes: repeat steps 5 to 6 using each additional remote.



08 Set ignition to OFF position.



09 The remote starter LED will turn OFF and the antenna LED will turn OFF.



10 The parking lights will flash twice [2x], the horn will chirp twice [2x].



11 Remote Programming completed.

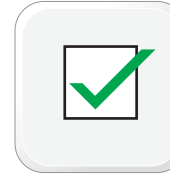

>>  TO DELETE ALL REMOTES: repeat steps 1 to 4 then press and hold the antenna button for 6 seconds. The parking lights will flash twice [2x], the horn will chirp twice [2x].

>>



The following procedure is valid for PRESTIGE and PURSUIT RF kits. It triggers the Valet Mode for remote start only.

01



NOTE: In Valet Mode, the Remote starter is not functional. Keyless entry, Lock and Unlock will remain functional.

02



Set ignition to OFF position.

03



Press and hold the antenna button.

04



Cycle ignition ON three times [3x ON/OFF] rapidly.

05



The parking lights will flash once [1x], the horn will chirp once [1x], the antenna LED will flash twice [2x] rapidly then once [1x].

06



Valet Mode completed.

07



To exit valet mode, repeat steps 2 to 4. The parking lights will flash twice [2x], the horn will chirp twice [2x], the antenna LED will turn OFF.

>>



The following procedure is valid for PRESTIGE and PURSUIT RF kits. It triggers the Valet Mode for alarm only.

01



NOTE: In Valet Mode, the alarm is disabled and the Remote starter is functional. Keyless entry, Lock and Unlock will remain functional.

02



Set ignition to ON position.

03



Press and hold the antenna button for 5 seconds.

04



The parking lights will flash once [1x], the horn will chirp once [1x], the antenna LED will turn ON.

05



Set ignition to OFF position.

06



Valet Mode completed.

07



To exit valet mode, repeat steps 2 to 3. The parking lights will flash twice [2x], the horn will chirp twice [2x], the antenna LED will turn OFF.

>>



The following procedure is valid for PRESTIGE and PURSUIT RF kits. It triggers the Valet Mode for remote start and alarm if the alarm override option is set to valet switch (Menu 3, Option 22).

01



NOTE: In Valet Mode, the Remote starter is not functional. Keyless entry, Lock and Unlock will remain functional.

02



Cycle ignition ON twice [2x OFF/ON] rapidly.

03



Press and release the BRAKE pedal three times [3x].

04



The parking lights will flash once [1x], the horn will chirp once [1x], the antenna LED will turn ON.

05



Set ignition to OFF position.

06



Valet Mode completed.

07



To exit valet mode, repeat steps 2 to 3. The parking lights will flash twice [2x], the horn will chirp twice [2x], the antenna LED will turn OFF.

>>



The following procedure is valid for PRESTIGE and PURSUIT RF kits. It triggers the Valet Mode with a custom code override. The default override code is 11.

01



NOTE: In Valet Mode, the Remote starter is not functional. Keyless entry, Lock and Unlock will remain functional.

02



Set ignition to ON position.

03



Press the antenna programming button once [1x].

04



Cycle ignition ON once [1x OFF/ON] rapidly.

05



Press the antenna programming button once [1x].

06



Cycle ignition ON once [1x ON/OFF] rapidly.

07



Set ignition to START position. (Engine running.)

08



Set ignition to OFF position.

09

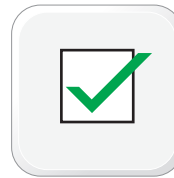

Valet Mode completed.

>>



The following procedure is valid for PRESTIGE and PURSUIT RF kits. It sets a new custom code override to trigger the Valet Mode.

01



Press once [1x] on the unlock button of the aftermarket remote.

02



Set ignition to ON position.

03



TIME RESTRICTION. Complete steps 4 to 9 within 45 seconds.

04



Press the antenna programming button three times [3x].

05



Cycle ignition ON three times [3x OFF/ON] rapidly.

06



Press the antenna programming button up to 9 times, to set the tenths digit from 1 to 9. Each button press increments the digit by one.

07



Cycle ignition ON once [1x OFF/ON] rapidly.

08



Press the antenna programming button up to 9 times, to set the tenths digit from 1 to 9. Each button press increments the digit by one.

09



Set ignition to OFF position.

10



LED will flash as many times as the tenths digit, then will flash as many times as the units digit.

11



Valet Mode completed.

WEB PROGRAMMABLE MENUS	DESCRIPTION
MENU 1 – Remote Starter	RS related configuration options
MENU 2 – Doorlock Options	Convenience feature configuration options
MENU 3 – Security Options	Alarm activation and settings
MENU 4 – AUX function assignments	Set transmitter AUX buttons controls
MENU 5 – Programmable outputs (POC)	Set actions for programmable outputs
MENU 6 – Pulse Timer Output Configuration (PTO)	Set duration for pulse timer outputs (if used)
MENU 7 – Input Configurations	Set inputs for Auto by firmware/Data/Analog
MENU 8 – Output Configurations	Set outputs for Auto by firmware/Data/Analog

Programming options are available through Weblink and Weblink Mobile only.

TEST MODULE		LED 1 STATUS	DIAGNOSTIC
I	DURING MODULE PROGRAMMING	Flashing RED	Missing/wrong information from firmware or vehicle.
		Solid RED	Module waiting for more vehicle information.
		Flashing GREEN	Additional steps required to complete module programming.
		Solid GREEN then OFF	Module correctly programmed.
		OFF	No activity or module already programmed.
II	DURING TACH PROGRAMMING	1 GREEN flash	Tach signal programmed in Analog
		2 GREEN flashes	Tach signal programmed in Data
		3 RED flashes	No tach signal detected
		4 RED flashes	System is in valet mode
		6 RED flashes	Tach set for 'assumed start'. No tach programming required
III	DURING REMOTE START	Flashing RED	Module incorrectly programmed.
		Solid RED	Module incorrectly programmed.
		Flashing GREEN	Module correctly programmed and operational.
		Solid GREEN then OFF	Reset in progress.
		OFF	Invalid ground when running status from remote starter.
IV	WITH IGNITION OFF	Flashing RED	Module incorrectly programmed or connected.
		Solid RED	Module not programmed. Waiting for more vehicle information.
		Flashing GREEN	False ground when running status from remote starter.
		Solid GREEN then OFF	Reset in progress.
		OFF	Module at rest and ready for a remote start sequence.

REMOTE STARTER ERROR CODES: NOTES	[X] NUMBER OF PARKING LIGHT FLASHES	DIAGNOSTIC
I WARNING: The following applies only when the parking lights are connected and supported by the system.	01	Engine running.
	02	Key in ignition at ON position.
II After a remote starter failure, the parking lights will flash three [3x] times, then will flash [X] number times to indicate an error code. See table.	03	Door is open.
	04	Trunk is open.
	05	Foot brake is ON.
	06	Hood is open.
	07	The reservation is OFF. (Manual transmission only)
	08	Tach failure.
	09	The vehicle is moving (VSS).
	10	System is in Valet Mode.
	11	CAN communication failure
	12	RS not synchronized. Start vehicle with OEM key for 15 sec before trying a new RS sequence.
	13	Bypass problem.

REMOTE STARTER SHUTDOWN ERROR CODES: NOTES	[Y] NUMBER OF PARKING LIGHT FLASHES	DIAGNOSTIC
I WARNING: The following applies only when the parking lights are connected and supported by the system.	01	Engine tach signal is lost.
	02	Emergency brake is lost.
II If the engine shuts down after a remote starter sequence: Press and hold the Trunk button and the Start button at the same time for 2.5 seconds when using a 1-WAY remote. OR Press once [1x] on button "4" when using a 2-WAY remote. The parking lights will flash four [4x] times, then will flash [Y] number times to indicate an error code. See table.	03	Foot brake is ON.
	04	Hood is open.
	05	Engine RPM limiter is ON.
	06	Glow plug timeout error.
	07	Vehicle is moving (VSS).
	08	N/A
	09	N/A
	10	Door is open.
	11	CAN communication failure during RS sequence.
	12	RS not synchronized. Start vehicle with OEM key for 15 sec before trying a new RS sequence.
	13	Takeover is not allowed.
	14	Shutdown error, board overheat protection.

>>



The following procedure resets the module programming to the vehicle. It does not reset any settings configured online.

01

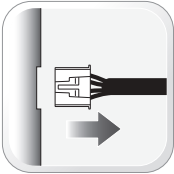

Disconnect all connectors from module except the M1 BLACK 8-pin connector and the M4 BLACK 20-pin connector.

02

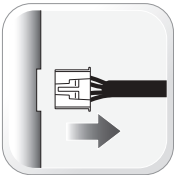

Disconnect the M1 BLACK 8-pin connector and the M4 BLACK 20-pin connector.

03



PRESS AND HOLD the module's programming button while connecting the M1 BLACK 8-pin connector and the M4 BLACK 20-pin connector.

04



Wait, LED 1 will flash RED. RELEASE programming button.

05

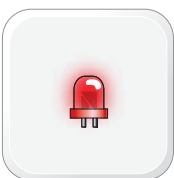

LED 1 will turn RED for 2 seconds.

06



Module RESET completed.

07

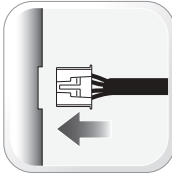

Reconnect all connectors.

08



Repeat programming procedure.

>>



Failure to follow procedure may result with a DTC or a CHECK ENGINE error message.

BOX CONTENTS

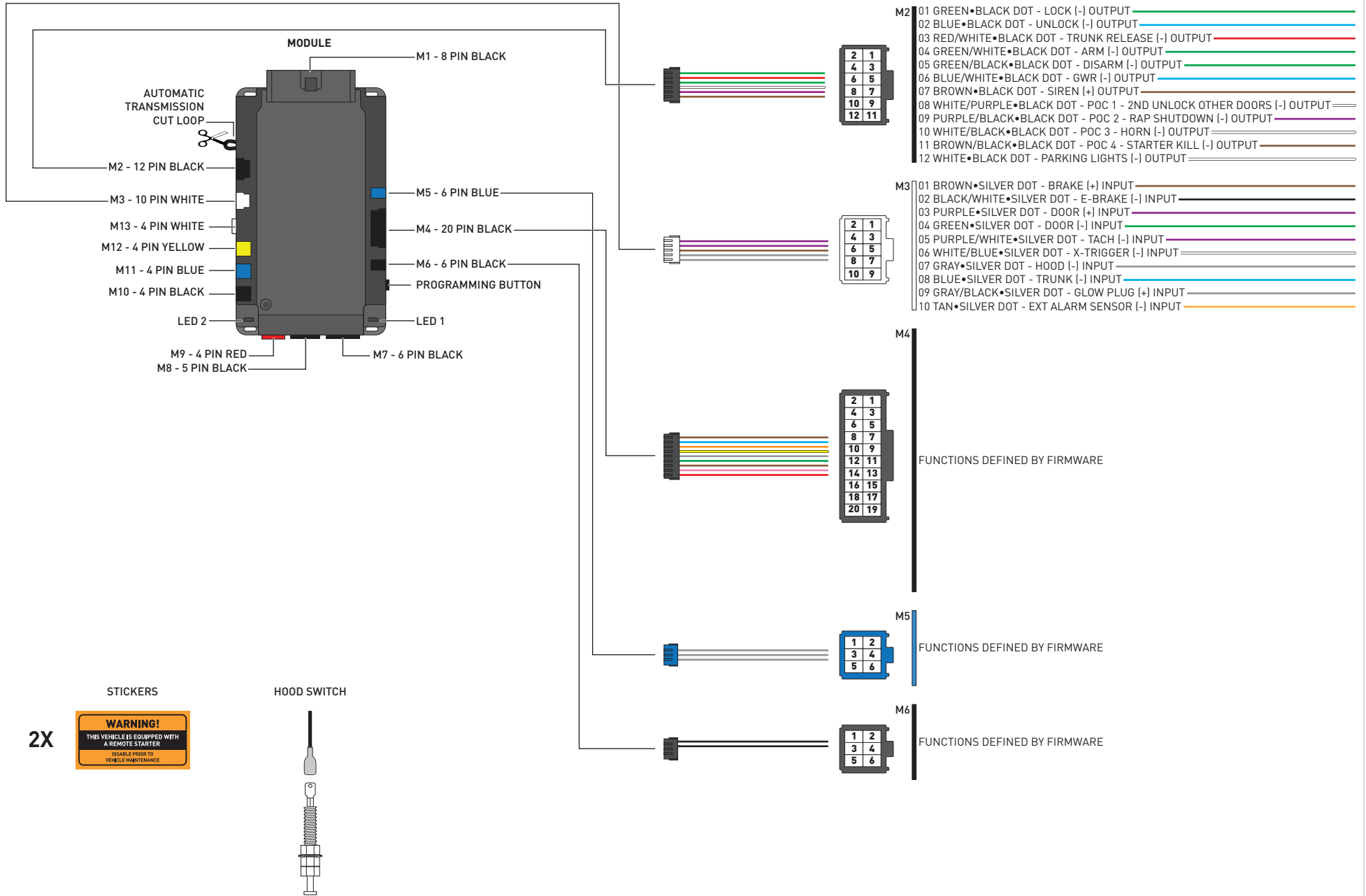

FLASHLOGIC: ADSAHRPWR **HIGH CURRENT HARNESS** **SOLD SEPARATELY**

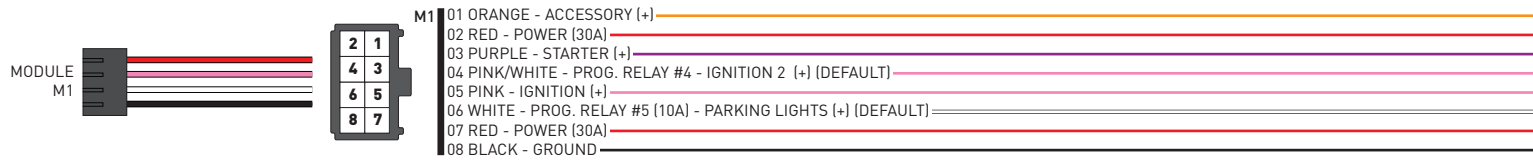

FLASHLOGIC: FLPROG **WEBLINK CABLE** **SOLD SEPARATELY**



FLASHLOGIC: FLWLMAN1, FLWLMP1 **WEBLINK MOBILE** **SOLD SEPARATELY**

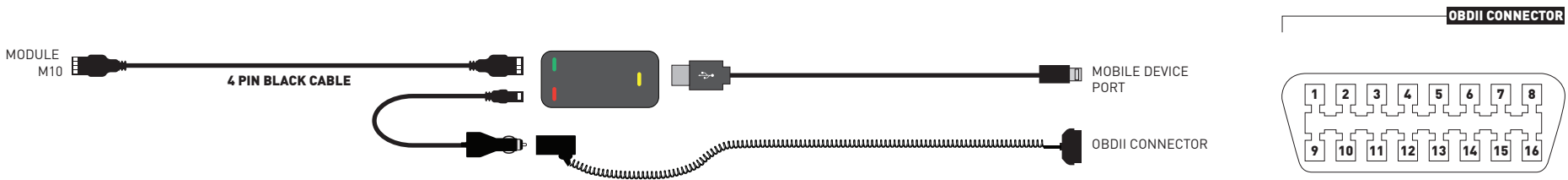

FLASHLOGIC: BASEC / VOXX: DUB1, CAGBS, MV3, AS9492A, AS94954P **SECURITY PACKAGE** **SOLD SEPARATELY**

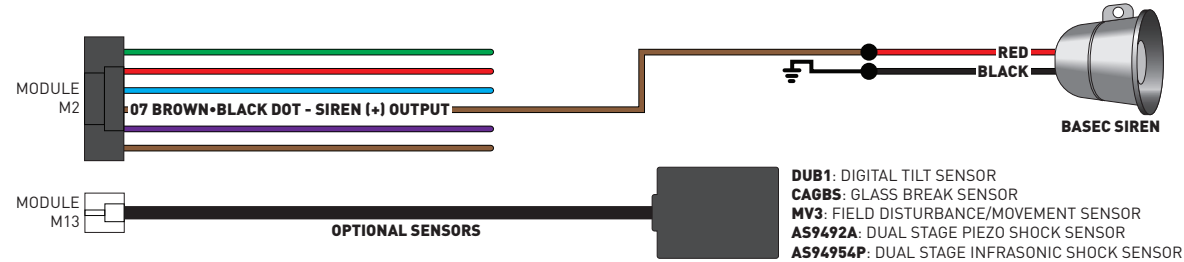

TO ACTIVATE THE BUILT-IN TILT & SHOCK SENSOR, THE SHOCK SENSOR PORT FOR COMPATIBLE ACCESSORIES AND THE SIREN OUTPUT:

- 1-LOG INTO YOUR WEBLINK ACCOUNT.
- 2-CONNECT YOUR CONTROL MODULE AND FOLLOW THE PROGRAMMING STEPS.
- 3-SELECT BASEC AND ENTER THE 16 DIGIT ACTIVATION CODE.
- 4-PROCEED WITH THE PROGRAMMING STEPS AND INSTALLATION.

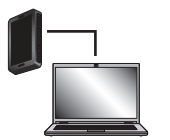

CODE ALARM: CA1B, BA1BTW

RF KIT

SOLD SEPARATELY



CODE ALARM: CA2LED, CA2LCD, CA4B

RF KIT

SOLD SEPARATELY



CARLINK: ASCL6, ASCLBTLR

TELEMATIC KIT

SOLD SEPARATELY



01



START vehicle for 15 seconds.

02



Press and hold the brake pedal.

03



Press and release the module's programming button. (OR if the remotes are already programmed to the vehicle, press and hold the start button of the remote for 2.5 seconds.)

04



Wait, LED 2 will flash GREEN. (See the Module Diagnostics page)

05





Release the brake pedal.

06



Module Programming Procedure completed.

>>  The following procedure is valid for CODE ALARM RF kits. It programs aftermarket remotes to the remote starter.

>>  WARNING: Program aftermarket remotes before usage. A maximum of four [4x] aftermarket remotes per system.

01 Set ignition to ON position.



02 Press and hold the antenna button for 10 seconds.



03 The parking lights will flash three times [3x], the horn will chirp three times [3x].



04 The remote starter LED will turn RED and the antenna LED will flash.

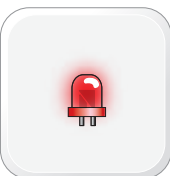

05 Press once [1x] on LOCK button of aftermarket remote.



06 The remote starter LED will flash GREEN once [1x] then will turn RED.



07 To program additional remotes: repeat steps 5 to 6 using each additional remote.



08 Set ignition to OFF position.



09 The remote starter LED will turn OFF and the antenna LED will turn OFF.



10 The parking lights will flash three times [3x].



11 Remote Programming completed.



>>



The following procedure is valid for CODE ALARM RF kits. It triggers the Valet Mode.

01



NOTE: In Valet Mode, the Remote starter is not functional. Keyless entry, Lock and Unlock will remain functional.

02



Set ignition to ON position.

03



Press and hold the antenna button for 5 seconds.

04



The parking lights will flash once [1x], the horn will chirp once [1x], the antenna LED will turn ON.

05



Set ignition to OFF position.

06



Valet Mode completed.

07



To exit valet mode, repeat steps 2 to 3. The parking lights will flash twice [2x], the horn will chirp twice [2x], the antenna LED will turn OFF.

>>



The following procedure is valid for CODE ALARM RF kits. It triggers the Valet Mode with a 3X LOCK configuration.

01



NOTE: In Valet Mode, the Remote starter is not functional. Keyless entry, Lock and Unlock will remain functional.

02



Cycle ignition ON twice [2x OFF/ON] rapidly.

03



Press and release the BRAKE pedal three times [3x].

04



The parking lights will flash once [1x], the horn will chirp once [1x], the antenna LED will turn ON.

05



Set ignition to OFF position.

06



Valet Mode completed.

07



To exit valet mode, repeat steps 2 to 3. The parking lights will flash twice [2x], the horn will chirp twice [2x], the antenna LED will turn OFF.

WEB PROGRAMMABLE MENUS	DESCRIPTION
MENU 1 – Remote Starter	RS related configuration options
MENU 2 – Doorlock Options	Convenience feature configuration options
MENU 3 – Security Options	Alarm activation and settings
MENU 4 – AUX function assignments	Set transmitter AUX buttons controls
MENU 5 – Programmable outputs (POC)	Set actions for programmable outputs
MENU 6 – Pulse Timer Output Configuration (PTO)	Set duration for pulse timer outputs (if used)
MENU 7 – Input Configurations	Set inputs for Auto by firmware/Data/Analog
MENU 8 – Output Configurations	Set outputs for Auto by firmware/Data/Analog

Programming options are available through Weblink and Weblink Mobile only.

TEST MODULE		LED 1 STATUS	DIAGNOSTIC
I	DURING MODULE PROGRAMMING	Flashing RED	Missing/wrong information from firmware or vehicle.
		Solid RED	Module waiting for more vehicle information.
		Flashing GREEN	Additional steps required to complete module programming.
		Solid GREEN then OFF	Module correctly programmed.
		OFF	No activity or module already programmed.
II	DURING TACH PROGRAMMING	1 GREEN flash	Tach signal programmed in Analog
		2 GREEN flashes	Tach signal programmed in Data
		3 RED flashes	No tach signal detected
		4 RED flashes	System is in valet mode
		6 RED flashes	Tach set for 'assumed start'. No tach programming required
III	DURING REMOTE START	Flashing RED	Module incorrectly programmed.
		Solid RED	Module incorrectly programmed.
		Flashing GREEN	Module correctly programmed and operational.
		Solid GREEN then OFF	Reset in progress.
		OFF	Invalid ground when running status from remote starter.
IV	WITH IGNITION OFF	Flashing RED	Module incorrectly programmed or connected.
		Solid RED	Module not programmed. Waiting for more vehicle information.
		Flashing GREEN	False ground when running status from remote starter.
		Solid GREEN then OFF	Reset in progress.
		OFF	Module at rest and ready for a remote start sequence.

REMOTE STARTER ERROR CODES: NOTES	[X] NUMBER OF PARKING LIGHT FLASHES	DIAGNOSTIC
I WARNING: The following applies only when the parking lights are connected and supported by the system.	01	Engine running.
	02	Key in ignition at ON position.
II After a remote starter failure, the parking lights will flash three [3x] times, then will flash [X] number times to indicate an error code. See table.	03	Door is open.
	04	Trunk is open.
	05	Foot brake is ON.
	06	Hood is open.
	07	The reservation is OFF. (Manual transmission only)
	08	Tach failure.
	09	The vehicle is moving (VSS).
	10	System is in Valet Mode.
	11	CAN communication failure
	12	RS not synchronized. Start vehicle with OEM key for 15 sec before trying a new RS sequence.
	13	Bypass problem.

REMOTE STARTER SHUTDOWN ERROR CODES: NOTES	[Y] NUMBER OF PARKING LIGHT FLASHES	DIAGNOSTIC
I WARNING: The following applies only when the parking lights are connected and supported by the system.	01	Engine tach signal is lost.
	02	Emergency brake is lost.
II If the engine shuts down after a remote starter sequence: Press and hold the Trunk button and the Start button at the same time for 2.5 seconds when using a 1-WAY remote. OR Press once [1x] on button "4" when using a 2-WAY remote. The parking lights will flash four [4x] times, then will flash [Y] number times to indicate an error code. See table.	03	Foot brake is ON.
	04	Hood is open.
	05	Engine RPM limiter is ON.
	06	Glow plug timeout error.
	07	Vehicle is moving (VSS).
	08	N/A
	09	N/A
	10	Door is open.
	11	CAN communication failure during RS sequence.
	12	RS not synchronized. Start vehicle with OEM key for 15 sec before trying a new RS sequence.
	13	Takeover is not allowed.
	14	Shutdown error, board overheat protection.

>>



The following procedure resets the module programming to the vehicle. It does not reset any settings configured online.

01

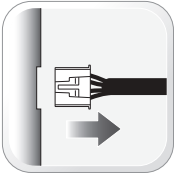

Disconnect all connectors from module except the M1 BLACK 8-pin connector and the M4 BLACK 20-pin connector.

02

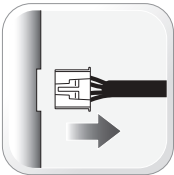

Disconnect the M1 BLACK 8-pin connector and the M4 BLACK 20-pin connector.

03



PRESS AND HOLD the module's programming button while connecting the M1 BLACK 8-pin connector and the M4 BLACK 20-pin connector.

04



Wait, LED 1 will flash RED. RELEASE programming button.

05

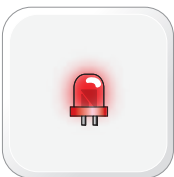

LED 1 will turn RED for 2 seconds.

06



Module RESET completed.

07

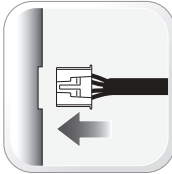

Reconnect all connectors.

08



Repeat programming procedure.

>>



Failure to follow procedure may result with a DTC or a CHECK ENGINE error message.

BOX CONTENTS

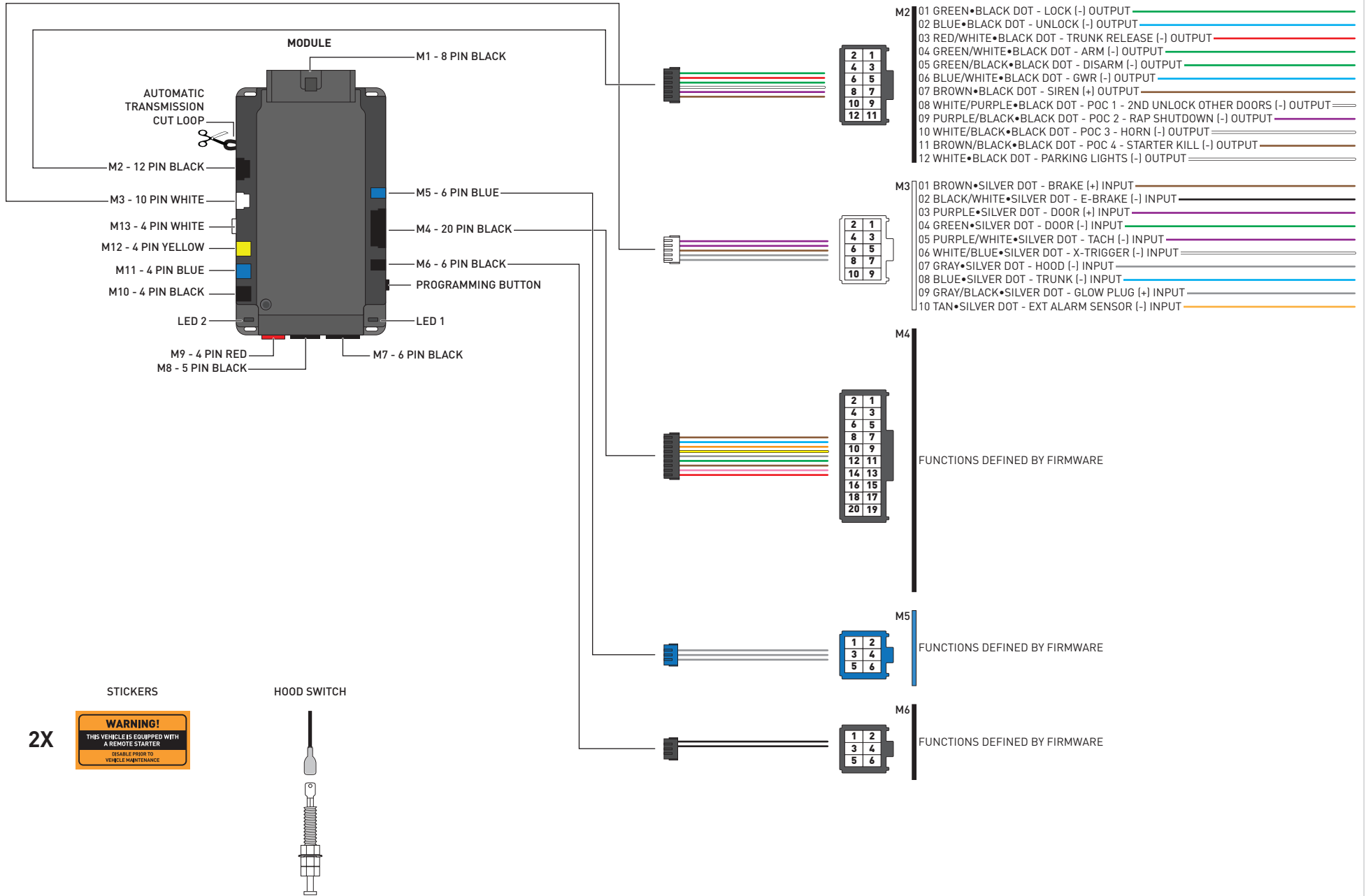

FLASHLOGIC: ADSAHRPWR **HIGH CURRENT HARNESS** **SOLD SEPARATELY**



FLASHLOGIC: FLPROG **WEBLINK CABLE** **SOLD SEPARATELY**



FLASHLOGIC: FLWLMAN1, FLWLMP1 **WEBLINK MOBILE** **SOLD SEPARATELY**

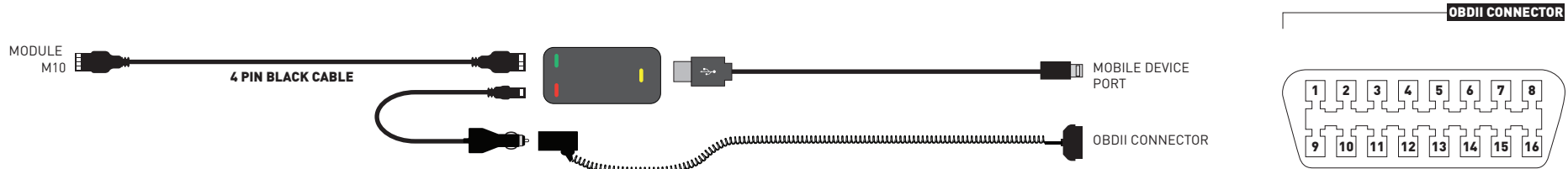

FLASHLOGIC: BASEC / VOXX: DUB1, CAGBS, MV3, AS9492A, AS94954P **SECURITY PACKAGE** **SOLD SEPARATELY**

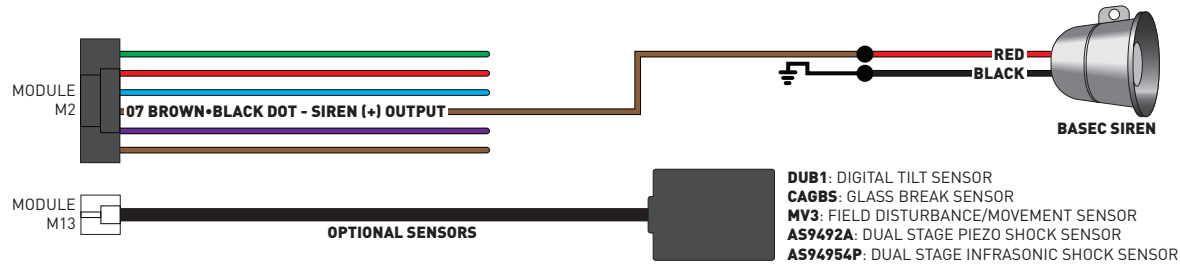

TO ACTIVATE THE BUILT-IN TILT & SHOCK SENSOR, THE SHOCK SENSOR PORT FOR COMPATIBLE ACCESSORIES AND THE SIREN OUTPUT:

- 1-LOG INTO YOUR WEBLINK ACCOUNT.
- 2-CONNECT YOUR CONTROL MODULE AND FOLLOW THE PROGRAMMING STEPS.
- 3-SELECT BASEC AND ENTER THE 16 DIGIT ACTIVATION CODE.
- 4-PROCEED WITH THE PROGRAMMING STEPS AND INSTALLATION.



DIRECTED: XL202 / FLASHLOGIC: ADSHRNRSL02

RF KIT

SOLD SEPARATELY

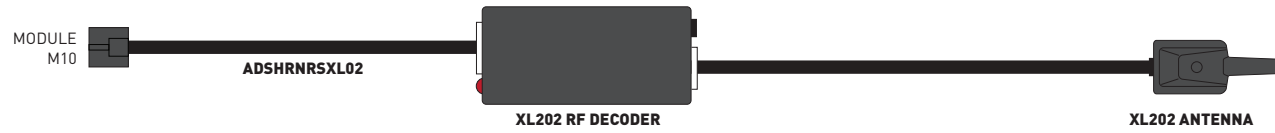

DIRECTED: SMARTSTART / FLASHLOGIC: ADSHRNSM01

TELEMATIC KIT

SOLD SEPARATELY

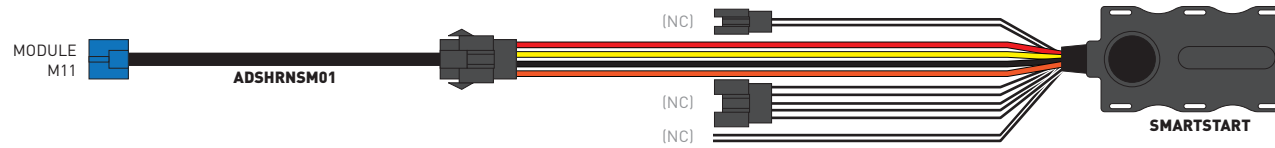

01



START vehicle for 15 seconds.

02



Press and hold the brake pedal.

03



Press and release the module's programming button. (OR if the remotes are already programmed to the vehicle, press and hold the start button of the remote for 2.5 seconds.)

04

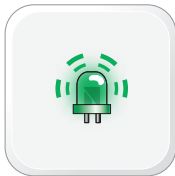

Wait, LED 2 will flash GREEN. (See the Module Diagnostics page)

05



Release the brake pedal.

06



Module Programming Procedure completed.

AFTERMARKET REMOTE PROGRAMMING: NOTES	
<p>I All aftermarket remotes must be programmed to the RF-Kit.</p> <p>Refer to the RF-Kit user guide for aftermarket remote features and programming procedures.</p>	

>>



The following procedure is valid for DIRECTED RF kits. It triggers the Valet Mode.

01



NOTE: In Valet Mode, the Remote starter is not functional. Keyless entry, Lock and Unlock will remain functional.

02



Time restriction. Complete next step within 7 seconds.

03



Cycle ignition ON twice [2x OFF/ON] rapidly.

04



Press and release the BRAKE pedal three times [3x].

05



Parking Light will flash once [1x] then will flash twice [2x].

06



Set ignition to OFF position.

07



Valet Mode completed.

08



To exit valet mode: repeat steps 2 to 6.

WEB PROGRAMMABLE MENUS	DESCRIPTION
MENU 1 – Remote Starter	RS related configuration options
MENU 2 – Doorlock Options	Convenience feature configuration options
MENU 3 – Security Options	Alarm activation and settings
MENU 4 – AUX function assignments	Set transmitter AUX buttons controls
MENU 5 – Programmable outputs (POC)	Set actions for programmable outputs
MENU 6 – Pulse Timer Output Configuration (PTO)	Set duration for pulse timer outputs (if used)
MENU 7 – Input Configurations	Set inputs for Auto by firmware/Data/Analog
MENU 8 – Output Configurations	Set outputs for Auto by firmware/Data/Analog

Programming options are available through Weblink and Weblink Mobile only.

TEST MODULE		LED 1 STATUS	DIAGNOSTIC
I	DURING MODULE PROGRAMMING	Flashing RED	Missing/wrong information from firmware or vehicle.
		Solid RED	Module waiting for more vehicle information.
		Flashing GREEN	Additional steps required to complete module programming.
		Solid GREEN then OFF	Module correctly programmed.
		OFF	No activity or module already programmed.
II	DURING TACH PROGRAMMING	1 GREEN flash	Tach signal programmed in Analog
		2 GREEN flashes	Tach signal programmed in Data
		3 RED flashes	No tach signal detected
		4 RED flashes	System is in valet mode
		6 RED flashes	Tach set for 'assumed start'. No tach programming required
III	DURING REMOTE START	Flashing RED	Module incorrectly programmed.
		Solid RED	Module incorrectly programmed.
		Flashing GREEN	Module correctly programmed and operational.
		Solid GREEN then OFF	Reset in progress.
		OFF	Invalid ground when running status from remote starter.
IV	WITH IGNITION OFF	Flashing RED	Module incorrectly programmed or connected.
		Solid RED	Module not programmed. Waiting for more vehicle information.
		Flashing GREEN	False ground when running status from remote starter.
		Solid GREEN then OFF	Reset in progress.
		OFF	Module at rest and ready for a remote start sequence.

REMOTE STARTER ERROR CODES: NOTES	[X] NUMBER OF PARKING LIGHT FLASHES	DIAGNOSTIC
I WARNING: The following applies only when the parking lights are connected and supported by the system.	01	Engine running.
	02	Key in ignition at ON position.
II After a remote starter failure, the parking lights will flash three [3x] times, then will flash [X] number times to indicate an error code. See table.	03	Door is open.
	04	Trunk is open.
	05	Foot brake is ON.
	06	Hood is open.
	07	The reservation is OFF. (Manual transmission only)
	08	Tach failure.
	09	The vehicle is moving (VSS).
	10	System is in Valet Mode.
	11	CAN communication failure
	12	RS not synchronized. Start vehicle with OEM key for 15 sec before trying a new RS sequence.
	13	Bypass problem.

REMOTE STARTER SHUTDOWN ERROR CODES: NOTES	[Y] NUMBER OF PARKING LIGHT FLASHES	DIAGNOSTIC
I WARNING: The following applies only when the parking lights are connected and supported by the system.	01	Engine tach signal is lost.
	02	Emergency brake is lost.
II If the engine shuts down after a remote starter sequence: Press and hold the Trunk button and the Start button at the same time for 2.5 seconds when using a 1-WAY remote. OR Press once [1x] on button "4" when using a 2-WAY remote. The parking lights will flash four [4x] times, then will flash [Y] number times to indicate an error code. See table.	03	Foot brake is ON.
	04	Hood is open.
	05	Engine RPM limiter is ON.
	06	Glow plug timeout error.
	07	Vehicle is moving (VSS).
	08	N/A
	09	N/A
	10	Door is open.
	11	CAN communication failure during RS sequence.
	12	RS not synchronized. Start vehicle with OEM key for 15 sec before trying a new RS sequence.
	13	Takeover is not allowed.
	14	Shutdown error, board overheat protection.

>>



The following procedure resets the module programming to the vehicle. It does not reset any settings configured online.

01

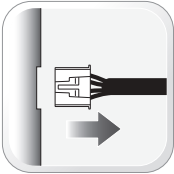

Disconnect all connectors from module except the M1 BLACK 8-pin connector and the M4 BLACK 20-pin connector.

02

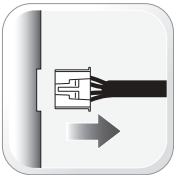

Disconnect the M1 BLACK 8-pin connector and the M4 BLACK 20-pin connector.

03



PRESS AND HOLD the module's programming button while connecting the M1 BLACK 8-pin connector and the M4 BLACK 20-pin connector.

04



Wait, LED 1 will flash RED. RELEASE programming button.

05

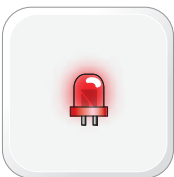

LED 1 will turn RED for 2 seconds.

06



Module RESET completed.

07

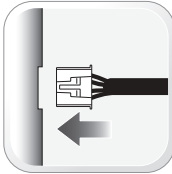

Reconnect all connectors.

08



Repeat programming procedure.

>>



Failure to follow procedure may result with a DTC or a CHECK ENGINE error message.